

# SUHRING

*Specialized In Supplying Parts Of Refrigeration System  
In Refrigerator And Air Conditioner*

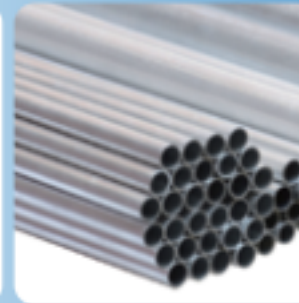

# Complex rings *Air-con installation application*

## Couplings : Aluminum Complex Rings

Part Number	British Standard	Metric Standard
CAZ0618	1/4"	6.35mm
CAZ0918	3/8"	9.52mm
CAZ1218	1/2"	12.7mm
CAZ1518	5/8"	15.88mm
CAZ1918	3/4"	19.05mm
CAZ2218	7/8"	22.22mm
CAZ2518	1"	25.4mm
CAZ2818	1 1/8"	28.6mm
CAZ3118	1 1/4"	31.8mm
CAZ3518	1 3/8"	34.9mm
CAZ3818	1 1/2"	38.1mm
CAZ4118	1 5/8"	41.3mm
CAZ4418	1 3/4"	44.45mm



## Couplings : Copper-steel Complex Rings

Part Number	British Standard	Metric Standard
CCZ0618	1/4"	6.35mm
CCZ0818	5/16"	8mm
CCZ0918	3/8"	9.53mm
CCZ1218	1/2"	12.7mm
CCZ1518	5/8"	15.88mm
CCZ1918	3/4"	19.05mm
CCZ2218	7/8"	22.22mm
CCZ2518	1"	25.4mm
CCZ2818	1 1/8"	28.6mm
CCZ3118	1 1/4"	31.8mm
CCZ3518	1 3/8"	34.9mm



# Complex rings *Air-con installation application*

## Reducers : Aluminum Complex Rings

Part Number	British Standard
CAZ0911	3/8"-1/4"
CAZ1211	1/2"-3/8"
CAZ1511	5/8"-1/2"
CAZ1911	3/4"-5/8"
CAZ2211	7/8"-3/4"
CAZ2511	1"-7/8"
CAZ2811	1 1/8"-1"
CAZ3111	1 1/4"-1 1/8"
CAZ3511	1 3/8"-1 1/4"
CAZ3811	1 1/2"-1 3/8"
CAZ4111	1 5/8"-1 1/2"
CAZ4411	1 3/4"-1 5/8"



## Reducers : Copper-steel Complex Rings

Part Number	British Standard
CCZ0811	5/16"-1/4"
CCZ0911	3/8"-1/4"
CCZ0912	3/8"-5/16"
CCZ1211	1/2"-3/8";
CCZ1511	5/8"-1/2"
CCZ1911	3/4"-5/8"
CCZ2211	7/8"-3/4"
CCZ2511	1"-7/8"
CCZ2811	1 1/8"-1"
CCZ3111	1 1/4"-1 1/8"
CCZ3511	1 3/8"-1 1/4"
CCZ3811	1 1/2"-1 3/8"
CCZ411	1 5/8"-1 1/2"
CCZ4411	1 3/4"-1 5/8"





# Complex rings

Refrigerator Repair Products

## Couplings : Aluminum Complex Rings

Part Number	Meter Standard
CAZ0208	1.85-1.85mm
CAZ0308	3-3mm
CAZ0401	4-1.85mm
CAZ0402	4.76-1.9mm
CAZ0403	4-2.6mm
CAZ0408	4.76-4.76mm
CAZ0409	4-4mm
CAZ0501	5-2mm
CAZ0601	6-1.85mm
CAZ0609	6-6mm
CAZ0608	1/4"/6.35-6.35mm
CAZ0702	7-1.85mm
CAZ0704	7-4mm
CAZ0703	7-4.76mm
CAZ0705	7-5mm
CAZ0709	7-7mm
CAZ0701	7.5-6mm
CAZ0708	7.5-7.5mm
CAZ0806	8-6mm
CAZ0801	8-6.35mm
CAZ0807	8-7mm
CAZ0857	8-7.5mm
CAZ0808	5/16"/8-8mm
CAZ0902	3/8"-5/16"



## Elbows

### Aluminum Elbows & Copper Elbows

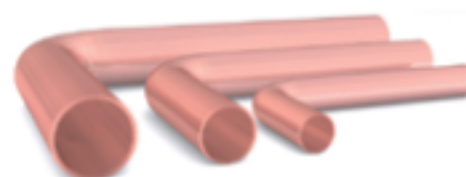

### Specification :

3/4"、7/8"、1"、1 1/8"、1 1/4"、1 3/8"、1 1/2"、1 5/8"、1 3/4"



# Complex rings

*Other General Applications*

## Other Products

Part Number	Metric Standard
CAZ0909	9mm
CAZ1209	12mm
CAZ0908	9.52mm
CAZ1208	12.7mm
CAZ0901	9.52-6.35mm
CAZ1201	12.7-9.52mm
CCZ0609	6mm
CCZ0608	6.35mm
CCZ0909	9mm
CCZ0908	9.53mm
CCZ1209	12mm
CCZ1208	12.7mm
CCZ0606	6.35-6mm
CCZ0903	9.52-9mm
CCZ1203	12.7-12mm
CCZ0901	9.52-6.35mm
CCZ1201	12.7-9.52mm
CCZ1501	15.88-12.7mm



**Stainless steel products designed for drinking water pipes and closed solar energy system**

Part Number	Metric Standard
CTZ1609	16mm
CAZ2209	22mm
CAZ2609	26mm



# Splitter connectors

Splitter connectors: Aluminium splitters. Copper splitters

Part Number	Branch tube	Dimensions-A			Dimensions-B			Dimensions-C		
		A1	A2	A3	B1	B2	B3	C1	C2	C3
SU22T	gas tube	3/4"	5/8"	1/2"	5/8"	1/2"		5/8"	1/2"	
	liquid tube	3/8"			3/8"	1/4"		3/8"	1/4"	
SU33T	gas tube	7/8"	3/4"		3/4"	5/8"		5/8"	1/2"	
	liquid tube	1/2"	3/8"		3/8"	1/4"		3/8"	1/4"	
SU72T	gas tube	1 1/4"	1 1/8"	1"	1"	3/4"	5/8"	3/4"	5/8"	1/2"
	liquid tube	5/8"	1/2"		1/2"	3/8"		1/2"	3/8"	1/4"
SU73T	gas tube	1 1/2"	1 1/4"		1 1/4"	1 1/8"	1"	1"	3/4"	5/8"
	liquid tube	3/4"	5/8"		3/4"	5/8"	1/2"	5/8"	1/2"	3/8"
SU75T	gas tube	1 3/4"	1 1/2"		1 1/2"	1 1/4"	1"	1 1/4"		
	liquid tube	7/8"	3/4"		3/4"	5/8"	1/2"	3/4"		

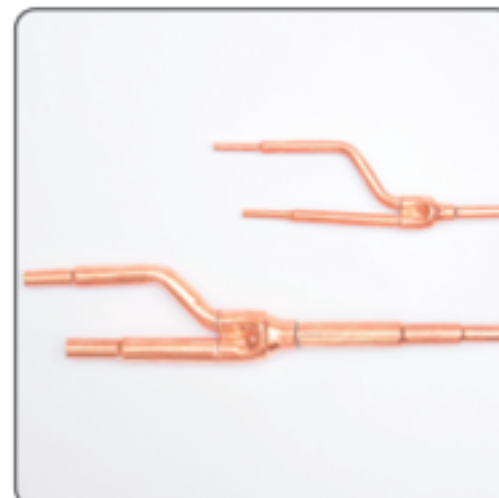
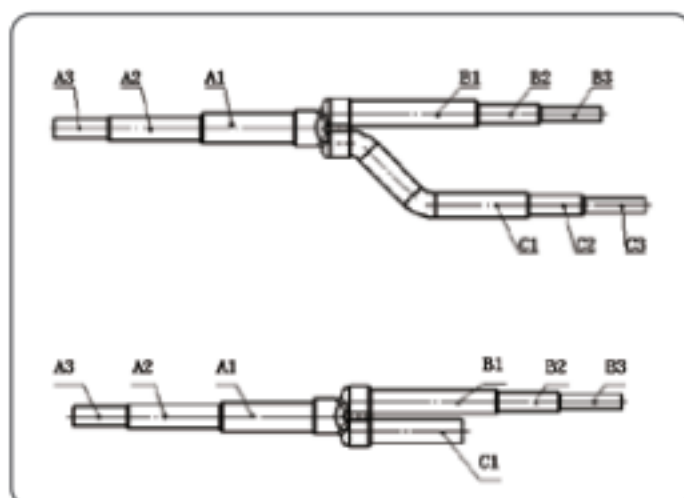

Part Number	Branch tube	Dimensions-A			Dimensions-B				Dimensions-C
		A1	A2	A3	B1	B2	B3	B4	C2
SU22MC90	gas tube	1 1/4"	1 1/8"		1 1/8"	1"	7/8"	3/4"	1"
	liquid tube	7/8"	3/4"	5/8"	1/2"	3/8"			5/8"
SU22MC135	gas tube 1	1 1/2"	1 1/4"		1 1/4"	1 1/8"			1"
	liquid tube 1	7/8"	3/4"		3/4"	5/8"			5/8"
	gas tube 2	1 1/4"	1 1/8"		1 1/8"	1"	7/8"	3/4"	1"
	liquid tube 2	3/4"	5/8"		1/2"	3/8"			5/8"

# Stoppers

*designed for mass production application, maintain, installation*

## Aluminum Stoppers. Copper-Steel Stoppers

Types	Part Number	Specification
Product line	SCP0602	6mm
	SCP0601	1/4"
Refrigerator Maintain	CAP0401	4mm
	CAP0403	5/16"
	CAP0602	6mm
	CAP0601	1/4"
Air Condition pressure testing	CCP0601	1/4"
	CCP0901	3/8"
	CCP1201	1/2"
	CCP1501	5/8"



## Insert

Part Number	Specification ( $\phi$ × wall )
NS0608	1/4"×0.8mm
NS0910	3/8"×1mm
NS1210	1/2"×1mm
NS1512	5/8"×1.2mm
NS1912	3/4"×1.2mm
NS2213	7/8"×.3mm
NS2513	1"×1.3mm
NS2815	1 1/8"×1.5mm
NS3115	1 1/4"×1.5mm
NS3515	1 3/4"×1.5mm





# Tools *Air-con installation application*



**SDY-25**

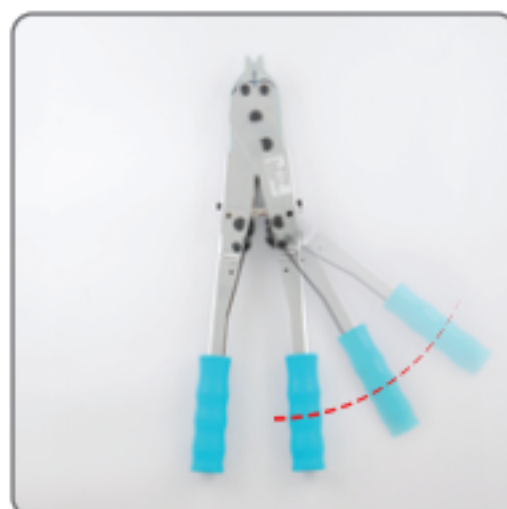

**SDY-25W**



**SHQ2 SHQ3**

## Application:

Dia. of tube  $\leq \Phi 19\text{mm}$  or  $3/4"$  Thickness of tube  $\leq 1.5\text{mm}$   
The sleeves will minimize because of pipe size and wall thickness issue.

## Advantage of Tools:

Easy to operate, Simple to master, No extended training required  
Cost Effective and easy maintenance



## FRK

FRK is designed especially for maintenance of refrigerator and freezer.

## Application:

Dia. of tube  $\leq \Phi 8\text{mm}$  or  $5/16"$  Thickness of tube  $\leq 1\text{mm}$   
The sleeves will minimize because of pipe size and wall thickness issue.

## Advantage of Tools:

Compact size, easy to carry and work confine space.  
For maintenance of R600a system, no hidden danger of burn or explosion.



## SDY-44 Portable rechargeably tool

Application: Dia. of tube  $\leq \Phi 28.6\text{mm}$  or  $1\ 1/8"$   
The sleeves will minimize because of pipe size and wall thickness issue.  
Product parameter:  
Lithium battery: 1.5AH  
Usage count: 80 times (subject to new battery, standard charging time and  $1\ 1/8"$  tube)  
Maintenance cycle: 20000 times for each cycle



# Tools *Air-con installation application*

## Double-cylinder crimping tool



Application: Dia. of tube  $\leq \Phi 45\text{mm}$  (or 1 3/4")

The sleeves will minimize because of pipe size and wall thickness issue.

### Types Of Pump



Hand Pump



Foot Pump



Electrical Pump

# Single ring



Single ring is commonly used in mass-production of refrigeration equipment, for connecting of refrigerant gas tubes. The sizes of tubes is relatively fixed.

## Instructions of Single Rings:

The tubing sizes in mass production of refrigeration equipments are relatively fixed, as well as specification and pretreatment of the tubings were designed with wall thickness  $< 2\text{mm}$ , pressure  $< 5\text{Mpa}$ , operating temperature from  $-50^{\circ}\text{C} \sim 150^{\circ}\text{C}$ .

Single rings are manufactured for specific application.

## Advantage of Single Rings:

Fast connection during production.

Simple technology, no increase of connecting joint.

Normal workers could also finish connection easily.

No chemical erosion on tubes, increased joint reliability, more efficient than conventional brazing, cost effective.



# Sealant

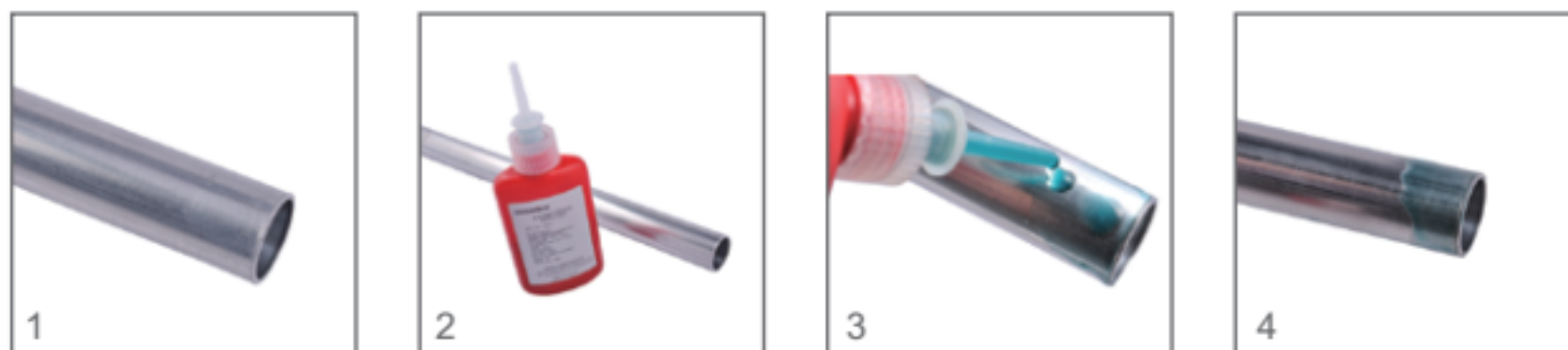

**Sealant SUP:**filled tiny scratch on the surface of metal tubes to ensure complete encapsulation.

It is unavoidable to have axial scratches on surface of metal tubes, during extrusion or drawing of cooper tubes, AL tubes, and TI alloy tubes. These scratch could not be completely sealed mechanically by the ferrets,SUP sealant is use to filled those tiny scratch.

SUP Sealant is formulated to use with SUHRING complex rings and single rings. SUP sealant will penetrate scratch and solidify during installation of Suhring connectors, which form a perfect surface for metal mechanical seal application. SUP have good elasticity and ductility after solidification, and will form soft membrane to make good encapsulation, within the specific temperature.

SUP is a anaerobic liquid with methacrylate. It will strengthen with epoxide by no need of solvent.

Coagulation time of SUP is subject to change by different base metal.

Reference Temp	Metal	Aluminum	Copper	Steel
23±2℃	Coagulation time	15min	30s	6min

SUP sealant and other kinds of sealant have already been accepted by almost all industries field. It is used in gas tubes, drinking water tubes and refrigerator tubes.

SUP sealant will reduce electrochemical corrosion, such as cooper & aluminum, cooper & Ti, cooper & iron, etc.

SUP sealant will form a protected membrane between two different metals to minimize the contact surface.

This will slowdown the electrochemical corrosion and ensure safe operation of pipes during their designed working life.

## Usage amount of SUP:

Apply an even coating on to be connecting pipe surfaces.

## Selection of sealant:

SUP-1: Temp -50℃ ~150℃ , applied in air condition and drinking water tubes。

SUP-2: Temp -50℃ ~150℃ , applied producing line and repairmen of refrigerators and freezers。

SUP-2: Temp -50℃ ~220℃ , applied in solar energy tubes。

## IMPORTER - DISTRIBUTOR



**MINH VIET TELECOMMUNICATION TRANDING - SERVICE CO.,LTD**

**ADD: 129 Le Dinh Tham St., Tan Quy Ward, Tan Phu District,HCM, Vietnam**

**Tel: (84.08) 5408 6789 Fax: (84.08) 5408 6789**

**Email: [sales@hosiwell.vn](mailto:sales@hosiwell.vn)**

## MANUFACTURER

**QINGDAO SUHRING CONNECT TECHNOLOGY CO.,LTD**

**Add: Xinli Road,Laoshan Area,Qingdao City,Shandong,China**

**International Sales:Emily Wang**

**TEL:0086-15666130258**

**Email: [export@suhring.com](mailto:export@suhring.com)**

**TEL: 0086-532-85980100**

**FAX: 0086-532-88915500**



*ISO9001 CERTIFICATE*