

SK-DC10IR/MS17RAI

IR DOME DVR Camera

Application : Wall & Ceiling Mount



Features

- 1/4" CMOS Sensor
- Resolution : D1
- Remote control supported
- Overwriting when memory is full
- 5, 15, 25(30) frame per second optional
- Max 32GB sd card used
- Recording mode : manual, motion detection, power up, scheduled
- 30pcs IR LED (0Lux 25M Range)

Camera Specification

SK-DC10IR/MS17RAI	
Imaging Sensor	1/4" CMOS Sensor
Resolution	704(H) × 576(V)
Recording Frame	25(30)fps@D1
S/N Ratio	More than 48dB (AGC Off)
Encoding	MPEG-4
Video Output	1.0 Vp-p (Sync Negative) Termination 75Ω
Min. Illumination	0Lux @ LED ON
AGC	AUTO
White Balance	AUTO
SD Card Capacity	2GB ~ 32GB support
Day & Night	TDN (Auto)
Lens	Vari-focal Lens(2.8~12mm, default)

Dimension

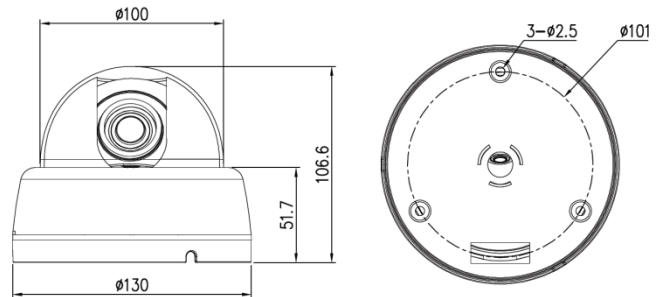

Structure specification

MECHANICAL	
Dimension	130(W) X 106.6(H) mm
Weight	Approx. 400g
ENVIRONMENT	
Construction	Plastic
Ingress Protection	-
Operating Temp	-10°C ~ 50°C
Humidity	0% to 90%
ELECTRICAL(Power Consumption)	
Supplied Voltage	DC12V ±10%
Current Consumption	Max. 400mA
CERTIFICATION	
CE, FCC, ROHS	Yes

Main Menu

