

KITZ SUPER Z

600 WOG / FULL PORT
TWO PIECE BRASS BALL VALVE

FEATURES :

Conforms to specification of MSS-SP-110
All sizes rated 600 WOG / 150 WSP
Blowout-proof stem
BS21 End connection
ANSI (NPT) B1.20.1 End connection also available
Two-piece construction with a chrome plated brass ball
Double "O"-ring stem seal and PTFE seats
Quick quarter-turn for easy operation

Application :

Water, Oil, Gas (residential), and Steam

Approvals: (for AKSZA)

CSA : 1/2 psig at the appliance

CSA : 5 psig from the appliance to the meter

CSA : 125 psig from the meter to the street

UL / FM : for Fire protection

Note : CSA – Canadian Standards Association

Consolidation of the American Gas Association (AGA) and the Canadian Gas Association (CGA)

UL - Underwriter's Laboratories

FM - Factory Mutual

Fig no. SZA / AKSZA



FIG no. SZA (for BS 21 thread ends)

AKSZA (for ANSI/NPT thread ends) – CSA, UL, FM Approval

Maximum Working Pressure

Working Pressure Non-Shock (psi)		Test Pressure (psi)	
Saturated Steam	Cold Water Oil Gas	Shell (Air)	Seat (Air)
150	600	900	80

Note: For more details, please refer to P-T rating chart.

Effective Length of Thread (MM)

Size	1/4"	3/8"	1/2"	3/4"	1"	1-1/4"	1-1/2"	2"
Super Z	8.5	9	12	13	15.5	16.5	16.5	19.5
ZA	7.5	8	10	11	12	13	14	16.5

MATERIALS :

NO.	PART	QTY	MATERIALS
1	Body	1	Forged Brass (B283 NoC37700)
2	Body Cap	1	Forged Brass (B283 NoC37700)
3	Stem	1	Brass Rod (B16)(3)
4	Ball	1	Forged Brass (B283 NoC37700)(1)
9	Handle	1	Carbon Steel(2)
10	Handle Nut	1	Carbon Steel
30	BallSeat	2	PTFE
45	O ring	2	FPM
47	Thrust Washer	1	PBT (4)
Test Pressure : Shell : 900 PSI (Hydrostatic) Seat : 80 PSI (Air)			
Standard : Face to Face or End to End : KITZ Standard End Connection : BS 21 (for SZA) @@ @@ ANSIB 120.1 (for AKSZA) ANSIB 16.18 (for CSZA) Wall Thickness : KITZ Standard			

NOTE : (1)CrPLATING
(2)ZNC DIHROMATE PLATED AND PLASTIC COVERING
(3)NiPLATING
(4)POLYBUTYLENE TEREPHTHALATE

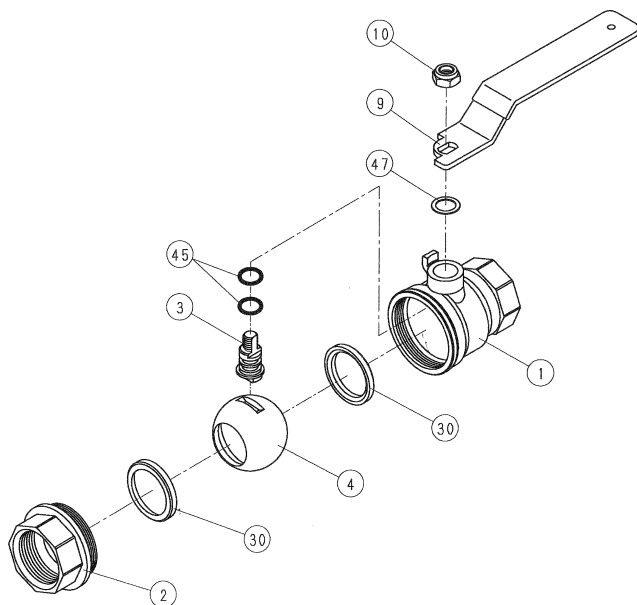

P-T Rating

DMENS DNS / Cv's

UNIT:MM

Fig no.SZA / AKSZA						
NOMINAL SIZE	d	H	D1	L	S1	Cv VALUE *
1/4	10	37	70	42	20	4.2
3/8	10	37	70	42	22	7.5
1/2	15	40	80	53	26	20.0
3/4	20	43	80	60	32	40.0
1	25	49	110	72	39	66.0
1-1/4	32	55	110	84	48	120.0
1-1/2	40	64	150	92	55	195.0
2	50	72	150	110	68	310.0

* Cv - Fbw rate in US GPM at a pressure drop of 1 psi

*Advisory Note :
Please be advised that applications in this shaded zone will reduce the service life of the valve.

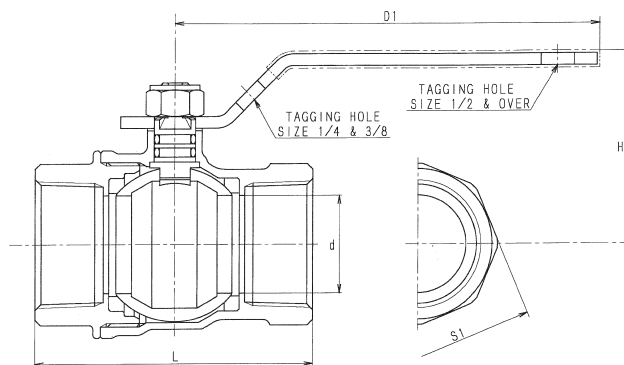

Packaging Data

	1/4"	3/8"	1/2"	3/4"	1"	1.1/4	1.1/2"	2"
Pcs per Master carton	96	96	72	60	36	36	16	6
Pcs per Inner carton	12	12	12	10	6	6	4	4

KITZ

KITZ CORPORATION

1-10-1, Nakase, Mihama-ku, Chiba 261-8577, Japan
International Sales Dept. Phone : 81-43-299-1732/1733 Fax: 81-43-299-0121